

# Kellergeschoß

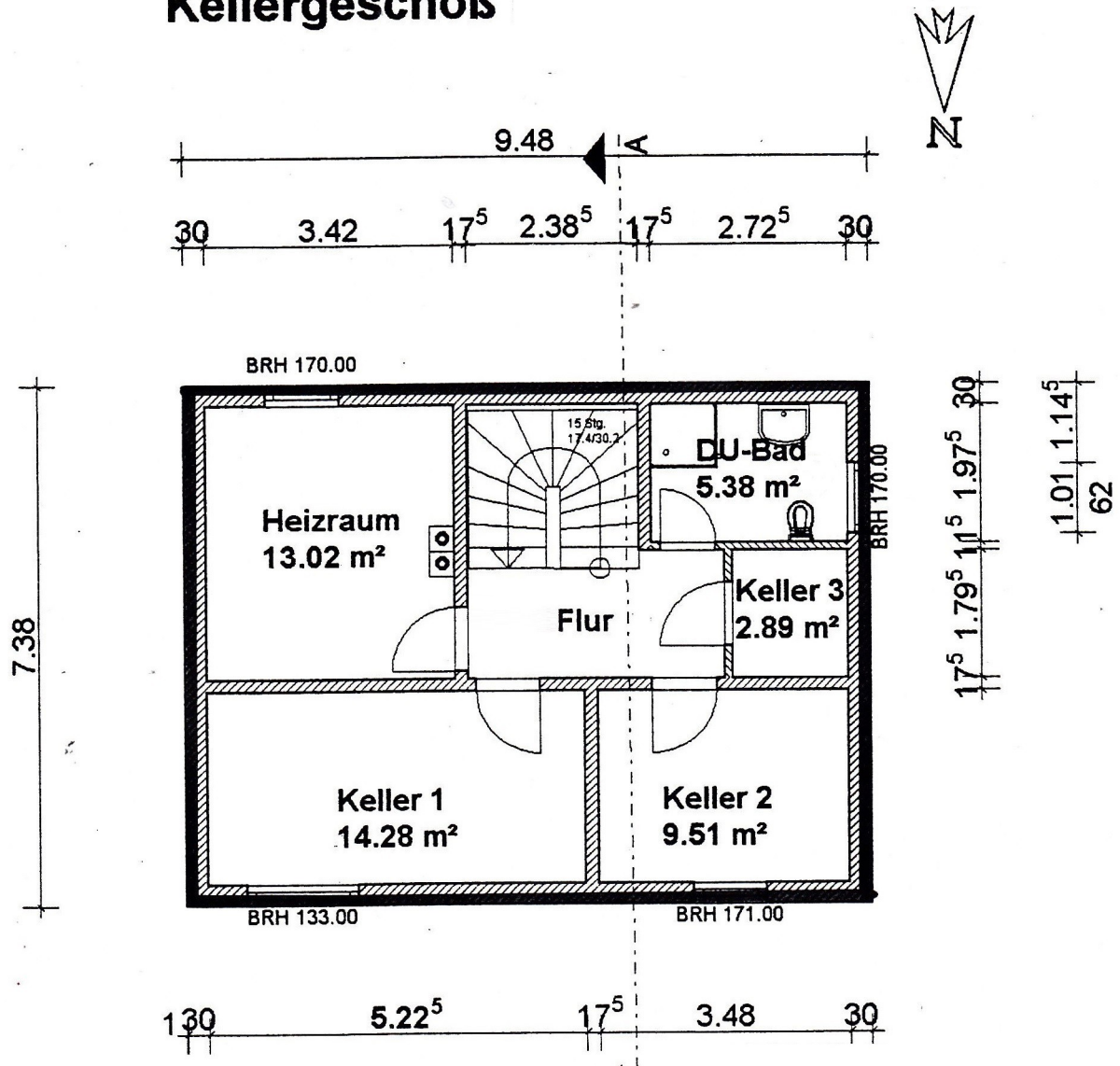

14,28 m<sup>2</sup>  
 + 9,51 m<sup>2</sup>  
 + 5,38 m<sup>2</sup>  
 + 2,89 m<sup>2</sup>  
 + 13,02 m<sup>2</sup> = 45,08 m<sup>2</sup> + Flur =

**50,02 m<sup>2</sup> Gesamtfläche Kellergeschoß**

# Erdgeschoß

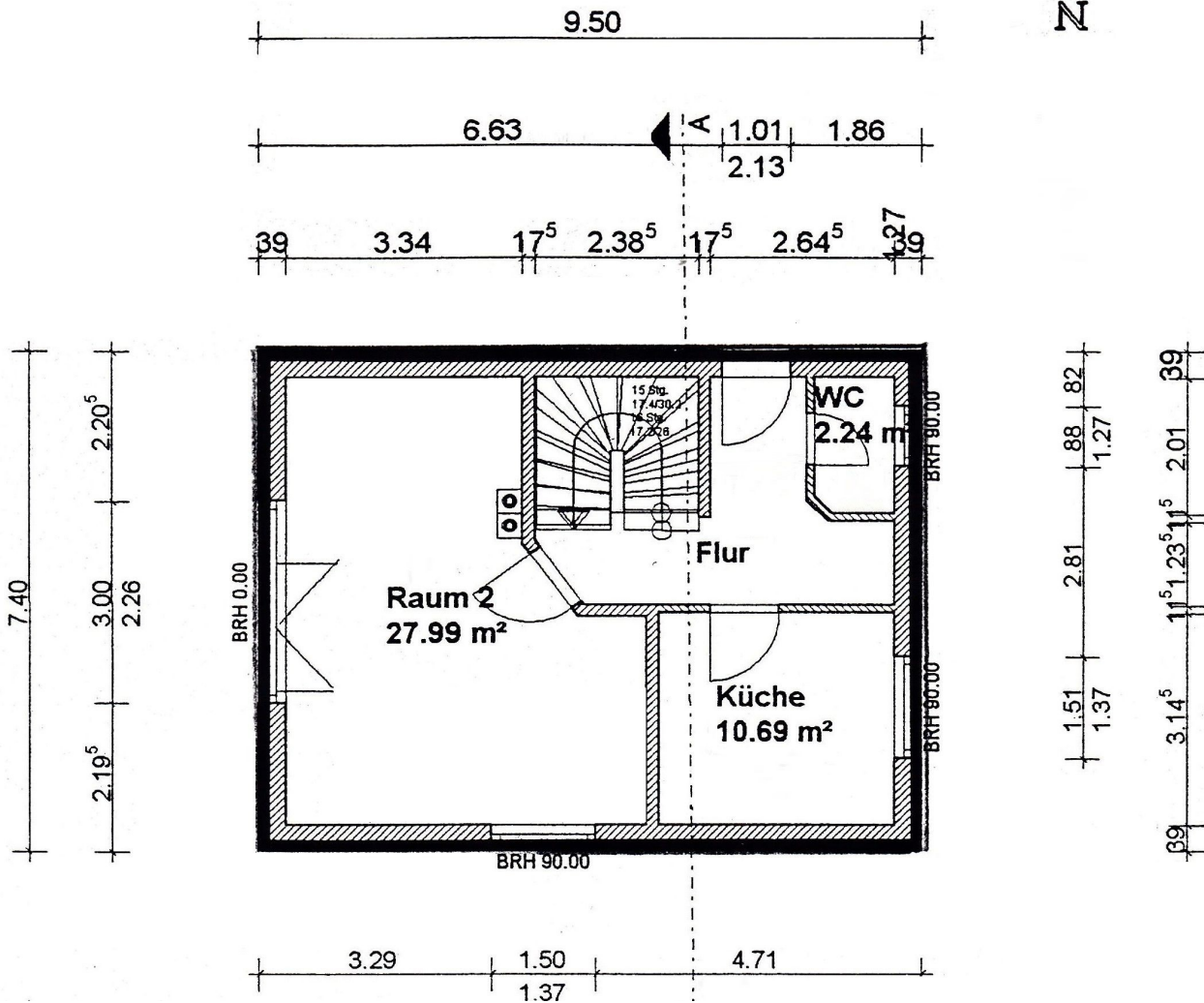

$$\begin{aligned}
 & 27,99 \text{ m}^2 \\
 & + 10,69 \text{ m}^2 \\
 & + 2,24 \text{ m}^2 = \underline{45,08 \text{ m}^2} + \text{Flur} =
 \end{aligned}$$

**51,55 m<sup>2</sup> Gesamtfläche Erdgeschoss**

# Dachgeschoß

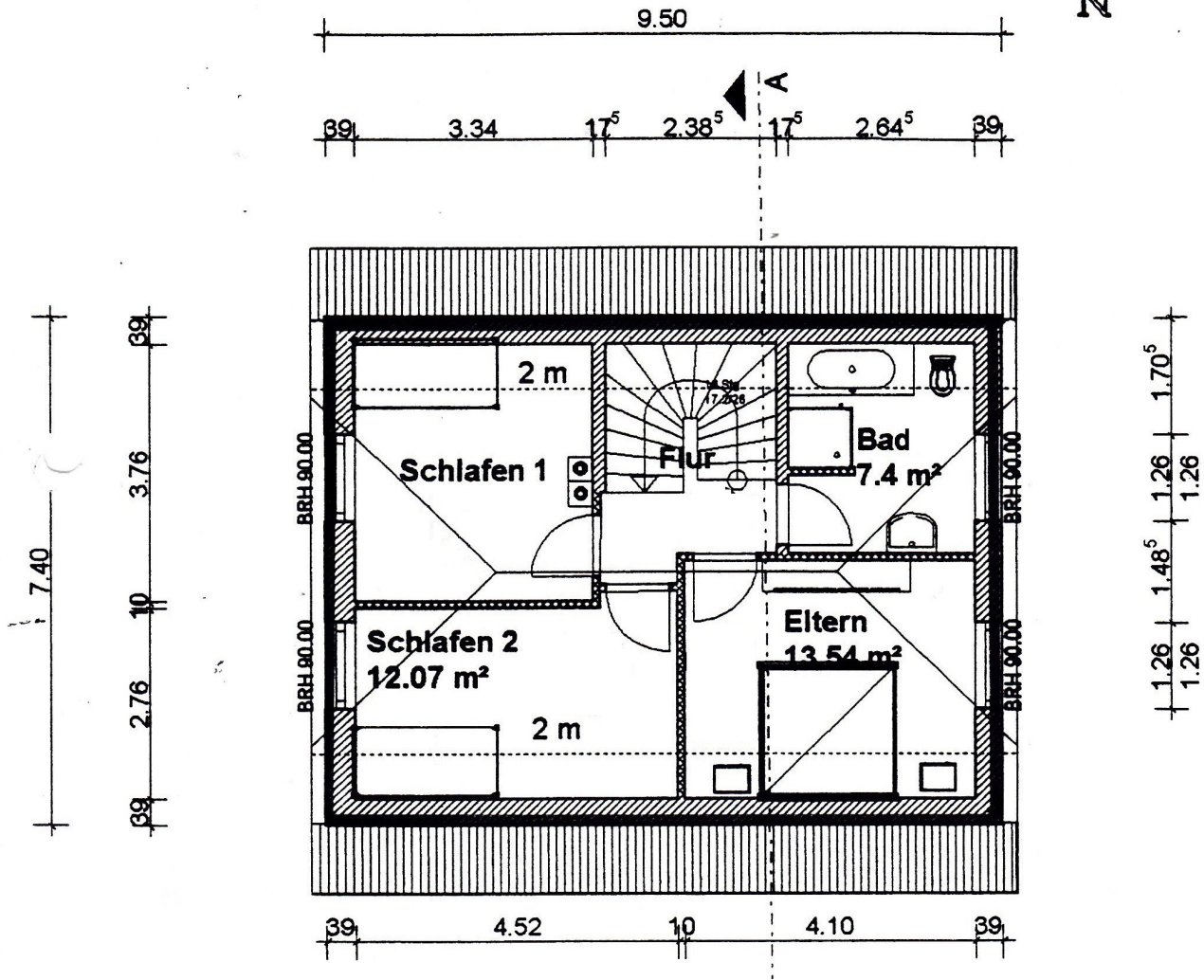

$$\begin{aligned}
 &12,07 \text{ m}^2 \\
 &+13,54 \text{ m}^2 \\
 &+12,57 \text{ m}^2 \\
 &+ 7,4 \text{ m}^2 = 45,58 \text{ m}^2 + \text{Flur} =
 \end{aligned}$$

50,02 m<sup>2</sup> - (Dachschräge) = **44,26 m<sup>2</sup> Netto Gesamtfläche Obergeschoss**